



How to Measure

[Perfect Fit]

Measuring, Assembly & Fitting Instructions

Measuring Instructions

Step 1.

Before you begin, ensure there is a clearance of 6mm all around the outside of your window beading to allow enough room for the Perfect Fit (Fig.1).



Step 2. Measure glass size

Measure the width and the drop of your glass size accurately with a digital measuring tape (P9480). We recommend that you measure in both corners and the middle of your window and use the smallest size taken (Fig. 2 & 3).

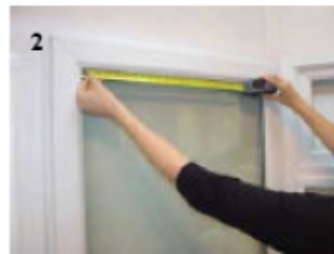

Step 3. Measure window depth

Measure the depth of the window (Fig. 4) using the depth gauge (P9481). This gives you the measurement from the face of the window frame to the glass (this is normally 20mm/24mm) and will determine the size of the window fixing brackets to be used.

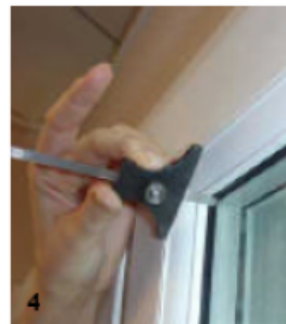

Assembly Instructions

Step 4. Fitting to Corner Pieces

All Perfect Fit Frames are supplied with the blind built in place on the top frame or to the bottom frame if skylight or P1400 pleated options are selected.

The top, bottom and side frames will need to be assembled.

This is achieved by sliding the side frames on either side into the pre-fitted corner pieces of first the top and then the bottom frame. Securing at the back using the screws provided (Fig. 5 & 6).

If skylight or P1400 pleated options are selected the headrail will need to be clipped into the pre-fixed clips.

Your frame is now ready for installation



For more information or help with fitting your blinds please call (0)20 8805 8809 or email info@furnishingworkshop.com